

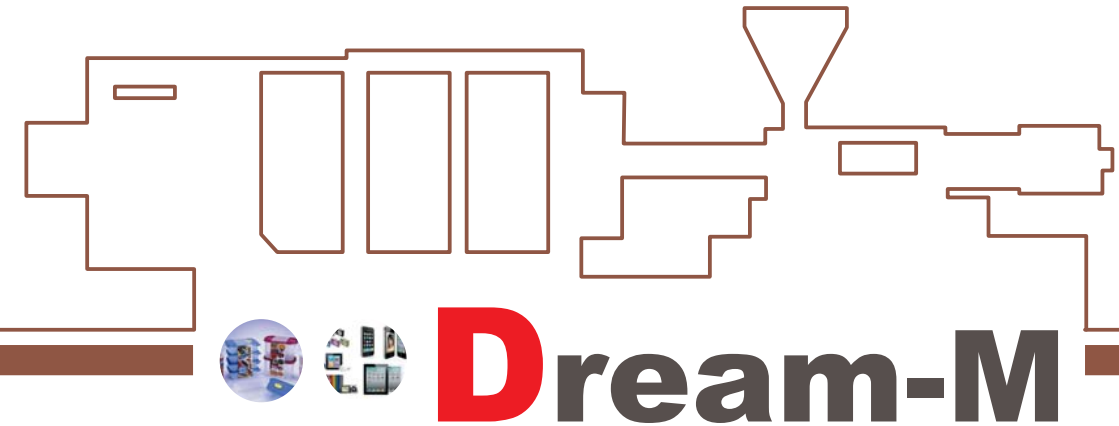

2014.3

TEDERIC



梦想超精密系列塑料注射成型机

TEDERIC

泰瑞机器股份有限公司
TEDERIC MACHINERY CO.,LTD

杭州经济技术开发区文泽北路245号

Add: No 245, North Wenzhe Road, Hangzhou

Economic & Technological Development Area, China

P.C.: 310018

TEL: +86-571-86733377 (内销) +86-571-86733389 (Overseas)

FAX: +86-571-87322905

E-mail: tederic@tederic-cn.com jgzheng@mail.hz.zj.cn

Http: www.tederic-cn.com



泰瑞机器 共塑梦想

TEDERIC MACHINERY MOLDING DREAMS

产品理念
Machine Design Concept



更专业的精密高速成型解决方案：
Professional solution for high speed injection

继承梦想系列诸多优点

With all the advantages of D series

单缸一线式低惯量注射机构

Single-cylinder linear injection unit with small inertia

高响应伺服系统

High response servo motor system

低阻力、高精度线性导轨

Linear guide with low resistance and high precision control

更有效的双缸整移

Double carriage cylinders.

更灵活的模块化设计

Flexible modularized design



3C专用方案：
Solution for 3C products

各类工程塑料专用塑化件

Professional plasticizing unit for engineering products.

加料口温度检测

Temperature monitoring for material feeding throat.

注射压力 $\geq 2300\text{bar}$

Injection pressure $\geq 2300\text{bar}$

注射速度 $\geq 150\text{mm/s}$

Injection speed $\geq 150\text{mm/s}$

开模位置闭环

Close loop control for mould open

注射位置闭环

Close loop control for injection position

力士乐高响应伺服系统

REXROTH high performance servo motor system

GEFRAN 高性能控制器

GEFRAN high reponse controller



更专业 >> 更精密 >> 更节能 >> 更高速 >> 更稳定

More professional >> More precise >>

More Power-saving >> High Speed and Stable





DREAM-M 系列技术参数表
 Technical parameter table

			单位 Unit	D45/150M			D60/150M			D80/210M			D100/370M		
				A	B	C	A	B	C	A	B	C	A	B	C
注射装置 Injection Unit	螺杆直径	Screw Diameter	mm	25	28	32	25	28	32	28	32	35	35	38	42
	螺杆长径比	Screw L/D Ratio		22.4	20.0	17.5	22.4	20.0	17.5	22.9	20	18.3	21.7	20.0	18.1
	理论容量	Theoretical Shot Volume	cm³	62	78	101	62	78	101	89	116	139	168	198	242
	注射重量 (PS)	Injection Weight(PS)	g	56	71	92	56	71	92	81	105	126	153	181	221
	注射压力	Injection Pressure	MPa	252.7	201.5	154.2	252.7	201.5	154.2	246.1	188.4	157.5	223.2	189.4	155.0
	对空注射速率	Injection Rate Into Air	cm³/s	57.0/85.5	71.5/107.3	93.4/140.1	57.0/85.5	71.5/107.3	93.4/140.1	58.5/87.8	76.5/114.7	91.5/137.2	96.8/119.2	114.1/140.5	139.4/171.6
	注射行程	Injection Stroke	mm	126			126			144			175		
	注射线速度	Injection Speed	mm/s	116/174			116/174			95/143			101/124		
	注射线速度(ACC)	Injection Speed(ACC)	mm/s	306			306			308			312		
	螺杆转速	Screw Rotation Speed	rpm	239/358			239/358			210/315			218/268		
合模装置 Clamping Unit	合模力	Clamping Force	kN	450			600			800			1000		
	移模行程	Clamping Stroke	mm	330			330			330			360		
	拉杆内距	Tie Bar Distance	mm	320x320			320x320			320x320			360x360		
	最大模厚	Max.Mold Height	mm	330			330			330			380		
	最小模厚	Min.Mold Height	mm	120			120			120			150		
	顶出行程	Eject Stroke	mm	80			80			80			120		
	顶出力	Eject Force	kN	28			28			28			34		
	顶出杆根数	No. of Ejector Pins	Piece	5			5			5			5		
其他 Others	最大油泵压力	Max.Pump Pressure	MPa	17.5			17.5			17.5			17.5		
	油泵马达功率	Pump Motor Power	kW	9/13			9/13			9/13			13/16		
	电热功率	Heater Power	kW	5.6			5.6			6.7			8.2		
	料斗容积	Hopper Capacity	L	25			25			25			25		
	油箱容积	Oil Tank Capacity	L	150			200			200			250		
	重量	Weight	t	2.6			2.7			2.8			3.2		

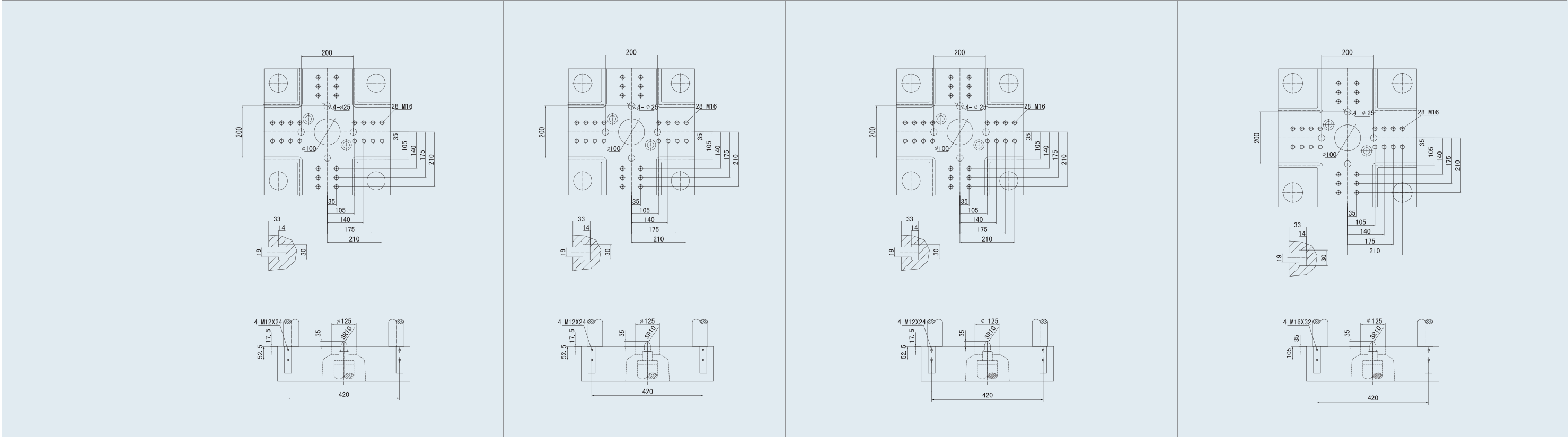

因设计更新，以上参数如有改动，恕不另行通知。以上为配置伺服系统时的参数，配置其他形式动力，参数将略有不同，详情请洽泰瑞公司。
 Due to continuous improvements,we reserve the right to amend any aspest of the above specifications without further notice.The above lists is for machine with servo motor system.
 For machine with other motor system,the parameters may be a little different.PPlease check with TEDERIC for the details .



DREAM-M 系列技术参数表
Technical parameter table

			单位 Unit	D130/520M			D160/640M			D200/840M			D250/1100M		
				A	B	C	A	B	C	A	B	C	A	B	C
注射装置 Injection Unit	螺杆直径	Screw Diameter	mm	38	42	45	42	45	50	45	50	55	50	55	60
	螺杆长径比	Screw L/D Ratio		22.1	20.0	18.7	21.4	20.0	18.0	22.2	20.0	18.2	22.0	20.0	18.3
	理论容量	Theoretical Shot Volume	cm³	221	270	310	287	329	406	358	442	535	497	601	715
	注射重量(PS)	Injection Weight (PS)	g	201	246	282	261	300	370	326	402	486	452	547	651
	注射压力	Injection Pressure	MPa	237.5	194.4	169.4	223.2	194.4	157.5	235.3	190.6	157.5	226.8	187.4	157.5
	对空注射速率	Injection Rate Into Air	cm³/s	112.0/140.0	136.8/171.0	157.0/196.3	119.2/149.0	136.8/171.0	168.9/211.1	141.3/176.7	174.5/218.1	211.1/263.9	183.3/224.8	221.7/272.0	263.9/323.7
	注射行程	Injection Stroke	mm	195			207			225			253		
	注射线速度	Injection Speed	mm/s	99/123			86/108			89/111			93/115		
	注射线速度(ACC)	Injection Speed(ACC)	mm/s	303			302			304			301		
	螺杆转速	Screw Rotation Speed	rpm	230/287			186/232			192/240			189/232		
合模装置 Clamping Unit	合模力	Clamping Force	kN	1300			1600			2000			2500		
	移模行程	Clamping Stroke	mm	430			480			540			550		
	拉杆内距	Tie Bar Distance	mm	420X420			470X470			530X530			580x580		
	最大模厚	Max.Mold Height	mm	460			530			560			600		
	最小模厚	Min.Mold Height	mm	160			200			220			250		
	顶出行程	Eject Stroke	mm	120			150			150			160		
	顶出力	Eject Force	kN	34			34			67			67		
	顶出杆根数	No. of Ejector Pins	Piece	5			5			9			9		
其他 Others	最大油泵压力	Max.Pump Pressure	MPa	17.5			17.5			17.5			17.5		
	油泵马达功率	Pump Motor Power	kW	16/20			16/20			20/25			25/31		
	电热功率	Heater Power	kW	11.8			12.9			15.9			19.7		
	料斗容积	Hopper Capacity	L	25			25			50			50		
	油箱容积	Oil Tank Capacity	L	300			350			400			550		
	重量	Weight	t	4.3			5			6.5			8		

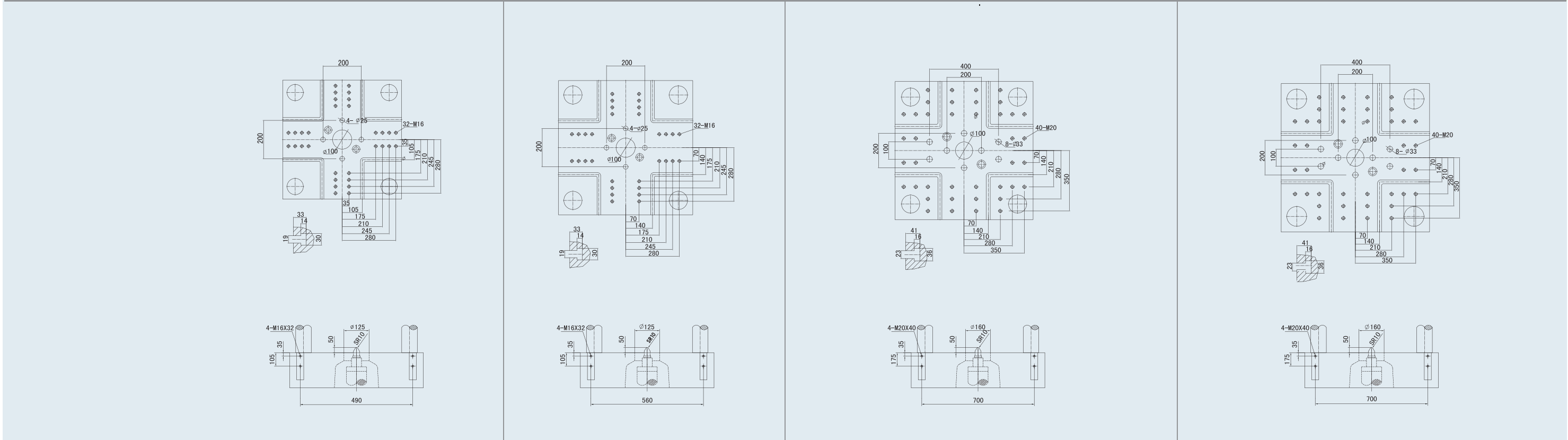

因设计更新，以上参数如有改动，恕不另行通知。以上为配置伺服系统时的参数，配置其他形式动力，参数将略有不同，详情请洽泰瑞公司。
Due to continuous improvements,we reserve the right to amend any aspect of the above specifications without further notice.The above lists is for machine with servo motor system.
For machine with other motor system,the parameters may be a little different.Please check with TEDERIC for the details.



DREAM-M 系列技术参数表
 Technical parameter table

			单位 Unit	D300/1500M			D350/1900M			D400/2500M			D450/2500M		
				A	B	C	A	B	C	A	B	C	A	B	C
注射装置 Injection Unit	螺杆直径	Screw Diameter	mm	55	60	65	60	65	70	65	70	75	65	70	75
	螺杆长径比	Screw L/D Ratio		21.8	20.0	18.5	21.7	20.0	18.6	23.7	22.0	20.5	23.7	22.0	20.5
	理论容量	Theoretical Shot Volume	cm³	656	780	916	845	992	1151	1161	1347	1546	1161	1347	1546
	注射重量(PS)	Injection Weight (PS)	g	597	710	833	769	903	1047	1057	1226	1407	1057	1226	1407
	注射压力	Injection Pressure	MPa	231.4	194.4	165.7	235.3	200.5	172.9	219.1	188.9	164.6	219.1	188.9	164.6
	对空注射速率	Injection Rate Into Air	cm³/s	220.3/263.4	262.2/313.5	307.7/367.9	216.7/259.1	254.3/304.1	294.9/352.7	273.1/341.4	316.8/396.0	363.7/454.6	273.1/341.4	316.8/396.0	363.7/454.6
	注射行程	Injection Stroke	mm	276			299			350			350		
	注射线速度	Injection Speed	mm/s	93/111			77/92			82/103			82/103		
	注射线速度(ACC)	Injection Speed(ACC)	mm/s	302			303			300			300		
	螺杆转速	Screw Rotation Speed	rpm	196/234			158/189			158/197			158/197		
合模装置 Clamping Unit	合模力	Clamping Force	kN	3000			3500			4000			4500		
	移模行程	Clamping Stroke	mm	650			690			750			800		
	拉杆内距	Tie Bar Distance	mm	630X630			680X680			730X730			780X780		
	最大模厚	Max.Mold Height	mm	650			700			750			780		
	最小模厚	Min.Mold Height	mm	250			280			280			300		
	顶出行程	Eject Stroke	mm	160			160			200			200		
	顶出力	Eject Force	kN	67			67			124			124		
	顶出杆根数	No.of Ejector Pins	Piece	13			13			13			17		
其他 Others	最大油泵压力	Max.Pump Pressure	MPa	17.5			17.5			17.5			17.5		
	油泵马达功率	Pump Motor Power	kW	31/37			31/37			36/45			36/45		
	电热功率	Heater Power	kW	23.8			30.6			32.7			32.7		
	料斗容积	Hopper Capacity	L	50			50			50			50		
	油箱容积	Oil Tank Capacity	L	700			750			800			800		
重量			t	9.8			12			14			16.5		

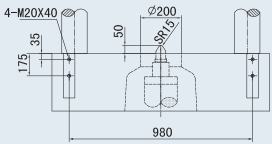
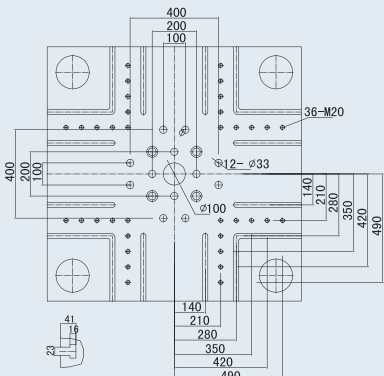
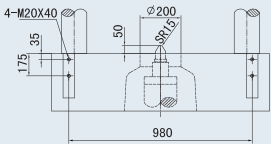
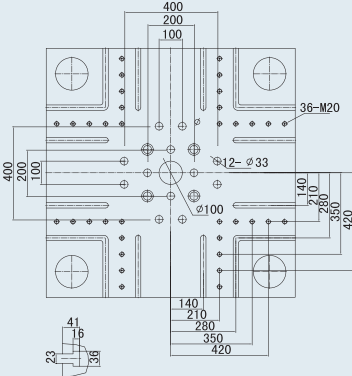
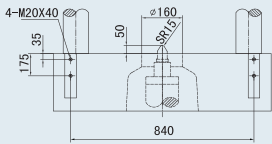
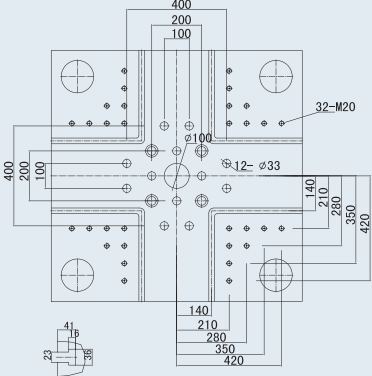
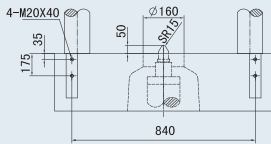
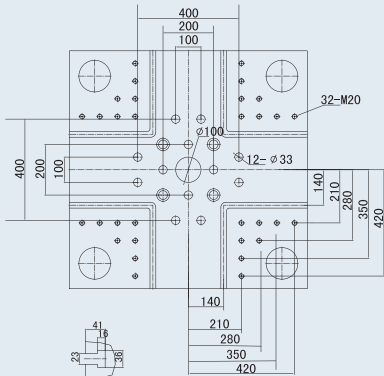

因设计更新，以上参数如有改动，恕不另行通知。以上为配置伺服系统时的参数，配置其他形式动力，参数将略有不同，详情请洽泰瑞公司。

Due to continuous improvements, we reserve the right to amend any aspect of the above specifications without further notice. The above lists are for machine with servo motor system. For machine with other motor system, the parameters may be a little different. Please check with TEDERIC for the details.



DREAM-M 系列技术参数表
 Technical parameter table

			单位	D500/3700M			D600/3700M			D650/5800M			D700/5800M		
			Unit	A	B	C	A	B	C	A	B	C	A	B	C
注射装置	螺杆直径	Screw Diameter	mm	75	80	85	75	80	85	85	90	100	85	90	100
	螺杆长径比	Screw L/D Ratio		23.5	22.0	20.7	23.5	22.0	20.7	23.3	22.0	19.8	23.3	22.0	19.8
	理论容量	Theoretical Shot Volume	cm³	1785	2031	2292	1785	2031	2292	2684	3009	3715	2684	3009	3715
	注射重量 (PS)	Injection Weight (PS)	g	1624	1848	2086	1624	1848	2086	2442	2738	3381	2442	2738	3381
	注射压力	Injection Pressure	MPa	210.3	184.8	163.7	210.3	184.8	163.7	218.0	194.4	157.5	218.0	194.4	157.5
	对空注射速率	Injection Rate Into Air	cm³/s	395.2/484.8	449.7/551.6	507.7/622.7	395.2/484.8	449.7/551.6	507.7/622.7	467.8/564.4	524.4/632.7	647.4/781.1	467.8/564.4	524.4/632.7	647.4/781.1
	注射行程	Injection Stroke	mm	404			404			473			473		
	注射线速度	Injection Speed	mm/s	90/110			90/110			82/100			82/100		
	注射线速度(ACC)	Injection Speed(ACC)	mm/s	301			301			295			295		
	螺杆转速	Screw Rotation Speed	rpm	157/193			157/193			100/121			100/121		
合模装置	合模力	Clamping Force	kN	5000			6000			6500			7000		
	移模行程	Clamping Stroke	mm	840			900			940			980		
	拉杆内距	Tie Bar Distance	mm	820X820			880X880			920X920			960X960		
	最大模厚	Max.Mold Height	mm	800			900			940			980		
	最小模厚	Min.Mold Height	mm	320			400			400			400		
	顶出行程	Eject Stroke	mm	200			260			260			260		
	顶出力	Eject Force	kN	124			182			182			182		
	顶出杆根数	No. of Ejector Pins	Piece	17			21			21			21		
其他	最大油泵压力	Max.Pump Pressure	MPa	17.5			17.5			17.5			17.5		
	油泵马达功率	Pump Motor Power	kW	50/61			50/61			61/74			61/74		
	电热功率	Heater Power	kW	45.9			45.9			54.9			54.9		
	料斗容积	Hopper Capacity	L	50			50			100			100		
	油箱容积	Oil Tank Capacity	L	900			900			1050			1050		
	重量	Weight	t	19			23			26			28		

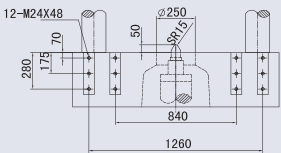
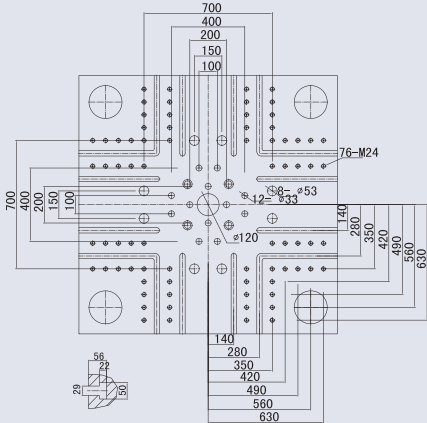
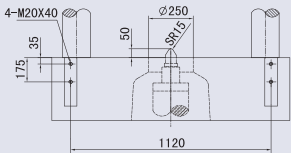
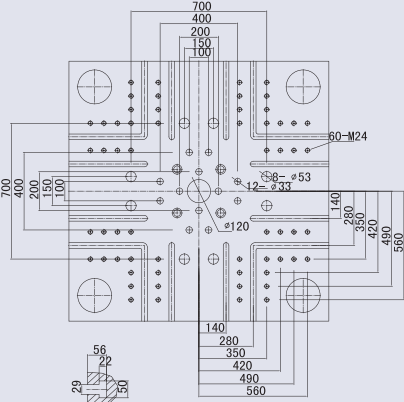
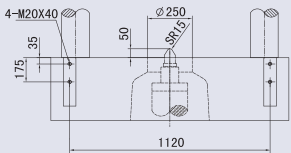
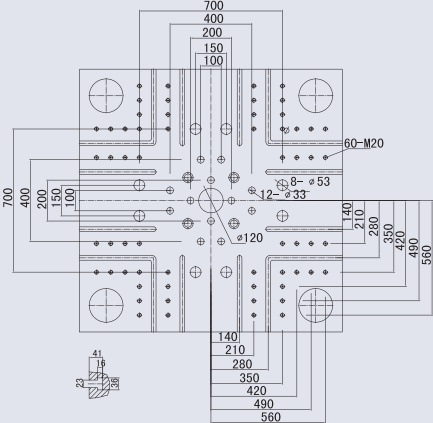
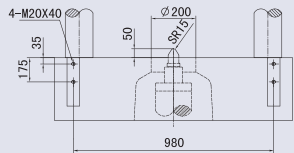
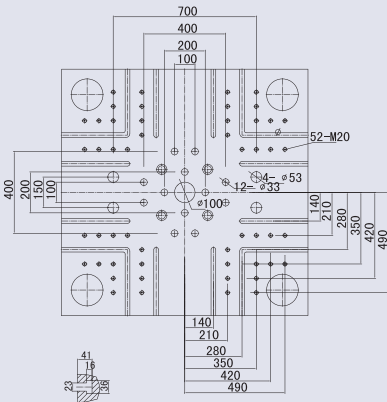

因设计更新，以上参数如有改动，恕不另行通知。以上为配置伺服系统时的参数，配置其他形式动力，参数将略有不同，详情请洽泰瑞公司。
 Due to continuous improvements, we reserve the right to amend any aspect of the above specifications without further notice. The above lists is for machine with servo motor system.
 For machine with other motor system, the parameters may be a little different. Please check with TEDERIC for the details.



DREAM-M 系列技术参数表
Technical parameter table

				D800/7200M			D900/7200M			D1050/9200M			
				A	B	C	A	B	C	A	B	C	D
注射装置 Injection Unit	螺杆直径	Screw Diameter	mm	90	100	110	90	100	110	100	110	120	130
	螺杆长径比	Screw L/D Ratio		24.4	22.0	20.0	24.4	22.0	20.0	24.2	22.0	20.2	18.6
	理论容量	Theoretical Shot Volume	cm³	3276	4045	4894	3276	4045	4894	4320	5227	6220	7300
	注射重量(PS)	Injection Weight (PS)	g	2981	3681	4454	2981	3681	4454	3931	4756	5661	6643
	注射压力	Injection Pressure	MPa	221.2	179.2	148.1	221.2	179.2	148.1	214.4	177.2	148.9	126.8
	对空注射速率	Injection Rate Into Air	cm³/s	563.6/691.3	695.8/853.5	841.9/1032.8	563.6/691.3	695.8/853.5	841.9/1032.8	682.4/814.3	825.8/985.3	982.7/1172.6	1153.3/1376.1
	注射行程	Injection Stroke	mm	515			515			550			
	注射线速度	Injection Speed	mm/s	89/109			89/109			87/104			
	注射线速度(ACC)	Injection Rate Into Air (ACC)	mm/s	290			290			294			
	螺杆转速	Screw rotation speed	rpm	86/106			86/106			92/110			
合模装置 Clamping Unit	合模力	Clamping Force	kN	8000			9000			10500			
	移模行程	Clamping Stroke	mm	1050			1130			1230			
	拉杆内距	Tie bar distance	mm	1020X1020			1080X1080			1160X1160			
	最大模厚	Max.Mold Height	mm	1020			1100			1160			
	最小模厚	Min.Mold Height	mm	450			500			500			
	顶出行程	Eject Stroke	mm	300			300			350			
	顶出力	Eject Force	kN	182			182			269			
	顶出杆根数	No.of Ejector Pins	Piece	21			21			21			
其他 Others	最大油泵压力	Max.Pump Pressure	MPa	17.5			17.5			17.5			
	油泵马达功率	Pump Motor Power	kW	75/92			75/92			88/105			
	电热功率	Heater Power	kW	69.2			69.2			78.1			
	料斗容积	Hopper Capacity	L	100			100			100			
	油箱容积	Oil Tank Capacity	L	1400			1400			1700			
	重量	Weight	t	36			42			48			

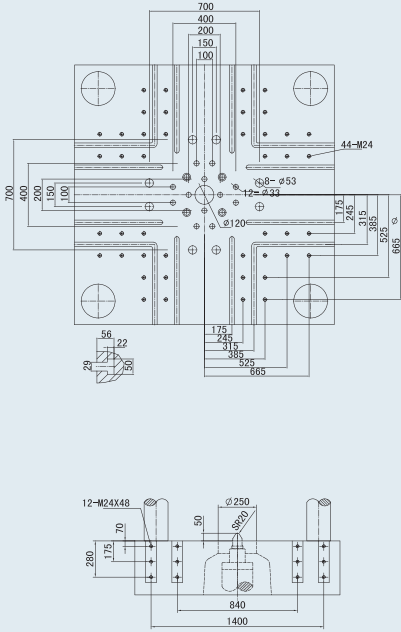
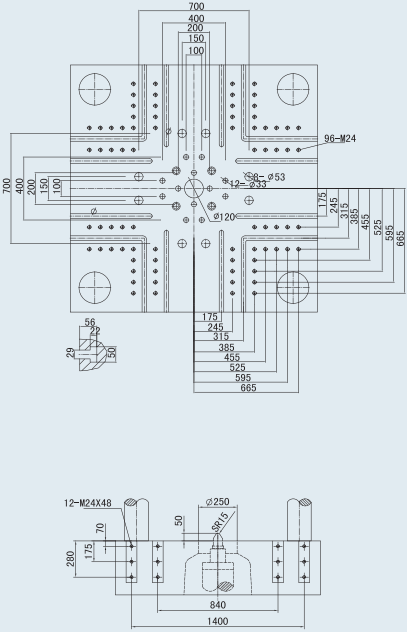
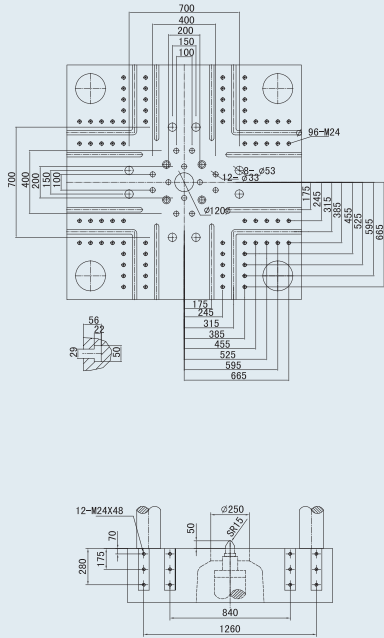

因设计更新，以上参数如有改动，恕不另行通知。以上为配置伺服系统时的参数，配置其他形式动力，参数将略有不同，详情请洽泰瑞公司。
Due to continuous improvements,we reserve the right to amend any aspest of the above specifications without further notice.The above lists is for machine with servo motor system.
For machine with other motor system,the parameters may be a little different.Please check with TEDERIC for the details.



DREAM-M3c 系列技术参数表
Technical parameter table

			单位 Unit	D80/150M	D100/150M	D130/210M	D160/370M	D200/520M	D250/640M	D300/840M	D350/1100M	D400/1500M
注射装置 Injection Unit	螺杆直径	Screw Diameter	mm	25	25	28	35	38	42	45	50	55
	螺杆长径比	Screw L/D Ratio		22.4	22.4	22.9	21.7	22.1	21.4	22.2	22.0	21.8
	理论容量	Theoretical Shot Volume	cm³	62	62	89	168	221	287	358	497	656
	注射重量(PS)	Injection Weight (PS)	g	56	56	81	153	201	261	326	452	597
	注射压力	Injection Pressure	MPa	252.7	252.7	246.1	223.2	237.5	223.2	235.3	226.8	231.4
	对空注射速率	Injection Rate Into Air	cm³/s	85.5	85.5	108.1	149.0	175	228.4	259.1	329.9	359.2
	注射行程	Injection Stroke	mm	126	126	144	175	195	207	225	253	276
	注射线速度	Injection Speed	mm/s	174	174	176	155	154	165	163	168	151
	注射线速度(ACC)	Injection Speed(ACC)	mm/s	306	306	308	312	303	302	304	301	302
	螺杆转速	Screw Rotation Speed	rpm	315	315	388	287	290	256	277	257	258
合模装置 Clamping Unit	合模力	Clamping Force	kN	800	1000	1300	1600	2000	2500	3000	3500	4000
	移模行程	Clamping Stroke	mm	330	360	430	480	540	550	650	690	750
	拉杆内距	Tie Bar Distance	mm	320X320	360X360	420X420	470X470	530X530	580X580	630X630	680X680	730X730
	最大模厚	Max.Mold Height	mm	330	380	460	530	560	600	650	700	750
	最小模厚	Min.Mold Height	mm	120	150	160	200	220	250	250	280	280
	顶出行程	Eject Stroke	mm	80	120	120	150	150	160	160	160	200
	顶出力	Eject Force	kN	28	34	34	34	67	67	67	67	124
	顶出杆根数	No.Of Ejector Pins	Piece	1	5	5	5	9	9	13	13	13
其他 Others	最大油泵压力	Max.Pump Pressure	MPa	17.5	17.5	17.5	17.5	17.5	17.5	17.5	17.5	17.5
	油泵马达功率	Pump Motor Power	kW	13	13	16	20	25	31	37	45	50
	电热功率	Heater Power	kW	5.6	5.6	6.7	8.2	11.8	12.9	15.9	19.7	23.8
	料斗容积	Hopper Capacity	L	25	25	25	25	50	50	50	50	50
	油箱容积	Oil Tank Capacity	L	175	175	300	350	400	550	700	750	850
重量			t	2.6	2.8	3.7	4.3	5.8	7.5	8.8	9.5	12

			单位 Unit	D450/1500M	D500/1900M	D600/1900M	D650/2500M	D700/2500M	D800/3700M	D900/3700M	D1050/5800M
注射装置 Injection Unit	螺杆直径	Screw Diameter	mm	55	60	60	65	65	75	75	85
	螺杆长径比	Screw L/D Ratio		21.8	21.7	21.7	23.7	23.7	23.5	23.5	23.3
	理论容量	Theoretical Shot Volume	cm³	656	845	845	1161	1161	1785	1785	2684
	注射重量(PS)	Injection Weight (PS)	g	597	769	769	1057	1057	1624	1624	2442
	注射压力	Injection Pressure	MPa	231.4	235.3	235.3	219.1	219.1	210.3	210.3	218.0
	对空注射速率	Injection Rate Into Air	cm³/s	359.2	433.4	433.4	561.5	561.5	727.3	727.3	800.8
	注射行程	Injection Stroke	mm	276	299	299	350	350	404	404	473
	注射线速度	Injection Speed	mm/s	151	153	153	169	169	165	165	141
	注射线速度(ACC)	Injection Speed(ACC)	mm/s	302	303	303	300	300	301	301	295
	螺杆转速	Screw Rotation Speed	rpm	258	269	269	232	232	231	231	168
	顶出杆根数	No.Of Ejector Pins	Piece	17	17	21	21	21	21	21	21
合模装置 Clamping Unit	合模力	Clamping Force	kN	4500	5000	6000	6500	7000	8000	9000	10500
	移模行程	Clamping Stroke	mm	800	840	900	940	980	1050	1130	1230
	拉杆内距	Tie Bar Distance	mm	780X780	820X820	880X880	920X920	960X960	1020X1020	1080X1080	1160X1160
	最大模厚	Max.Mold Height	mm	780	800	900	940	980	1020	1100	1160
	最小模厚	Min.Mold Height	mm	300	320	400	400	400	450	500	500
	顶出行程	Eject Stroke	mm	200	200	260	260	260	300	300	350
	顶出力	Eject Force	kN	124	124	182	182	182	182	182	269
	顶出杆根数	No.Of Ejector Pins	Piece	17	17	21	21	21	21	21	21
其他 Others	最大油泵压力	Max.Pump Pressure	MPa	17.5	17.5	17.5	17.5	17.5	17.5	17.5	17.5
	油泵马达功率	Pump Motor Power	kW	50	61	61	74	74	92	92	105
	电热功率	Heater Power	kW	23.8	30.6	30.6	32.7	32.7	45.9	45.9	54.9
	料斗容积	Hopper Capacity	L	50	50	50	100	100	100	100	100
	油箱容积	Oil Tank Capacity	L	850	900	900	1050	1050	1400	1400	1700
	重量	Weight	t	15	18.5	22	25	30	42	45	50

因设计更新，以上参数如有改动，恕不另行通知。以上为配置伺服系统时的参数，配置其他形式动力，参数将略有不同，详情请洽泰瑞公司。
Due to continuous improvements,we reserve the right to amend any aspect of the above specifications without further notice.The above lists is for machine with servo motor system.
For machine with other motor system,the parameters may be a little different.Please check with TEDERIC for the details.



功 能 配 置 表
Components & functions list

DREAM-M系列锁模力和注射当量搭配配置

Match list of clamping force and injection international size

锁模力\注射当量 Clamping Force / International Injection Size	i150	i210	i370	i520	i640	i840	i1100	i1500	i1900	i2500	i3700	i5800	i7200	i9200
D45	●	○												
D60	●	○												
D80	○	●	○											
D100		○	●	○										
D130			○	●	○									
D160				○	●	○								
D200					○	●	○							
D250						○	●	○						
D300							○	●	○					
D350								○	●	○				
D400									○	●	○			
D450									○	●	○			
D500										○	●	○		
D600										○	●	○		
D650											○	●	○	
D700											○	●	○	
D800												○	●	○
D900												○	●	○
D1050													○	●

● 标准 standard ○ 可选 Optional

DREAM-M系列功能配置表---注射部件

Components & Functions list—for Injection Unit

功 能 描 述 / 注 射 当 量	Function Description / Injection Unit	i150-840	i1100-1900	i2500-5800	i7200-9200
标准螺杆	Standard screw	●	●	●	●
其他螺杆	Special screw	○	○	○	○
锁闭式喷嘴	Shut off nozzle	○	○	○	○
单缸—线式注射结构	Single cylinder injection system	●	●	●	●
双缸座台移动	Two carriage cylinders	●	●	●	●
座台电子尺控制	Transducer control for carriage unit	●	●	●	●
螺杆转速显示	Screw RPM display	●	●	●	●
油马达予塑	Plasticizing with hydraulic motor	●	●	●	●
予塑背压比例控制	Propotional back pressure control	●	●	●	●
下料口温度监测	Temp monitoring for Material feed-throat	○	○	○	○
喷嘴防护罩	Nozzle shielded cover	●	●	●	●
料筒隔热防护	Barrel insulated	●	●	●	●
整移自锁阀	Self -lock valve for carriage forward	●	●	●	●
料筒支撑装置	Barrel supporting device				●
注射台旋转装置	Injection carriage turn out device			○	○
上料平台	Material loading platform			○	○
座台集中润滑装置	Carriage central lubrication device	○	○	●	●
座台自动集中润滑装置	Carriage central auto lubrication device	○	○	○	○
云母加热圈	Standard heater band	●	●	●	●
陶瓷加热圈	Ceramic heater band	○	○	○	○
电预塑	Plasticizing with servo motor	○	○		
丝杆移动加料斗	Screw rod feeding-type hopper	○	○	○	○
气体辅助注射接口	Gas assisted injection interface	○	○	○	○
微发泡成型	Micro foam forming molding	○	○	○	
干燥料斗	Hopper dryer	○	○	○	○
不锈钢料斗	Stainless hopper	●	●	●	

● 标准 standard ○ 可选 Optional

DREAM-M系列功能配置表---锁模部件

Components & Functions list—for Clamping unit

功 能 描 述 \ 锁 模 单 元	Function description / Clamping unit	D45-250	D300-450	D500-600	D650-1050
螺丝孔模板	Platen with thread hole	○	○	○	○
梯形槽模板	Platen with T slot	●	●	●	●
模板（欧规2模具安装尺寸）	Platen(EUROMAP 2 mould install dimension)	○	○	○	○
高刚性5铰链锁模机构	High rigid 5 points clamping unit.	●	●	●	●
机械、电气安全保护	Mechanical and electrical safety	●	●	●	●
液压安全保护	Hydraulic safety	●	●	●	●
液压马达调模	Hydraulic motor for mould height adjusting	●	●	●	●
自动调模功能	Auto- mould height adjusting function	●	●	●	●
开关模、脱模电子尺控制	Clamping & eject control with transducer	●	●	●	●
定量式自动集中润滑系统	Fix-quantity type auto central lubrication system			●	●
检知式自动集中润滑系统	Auto-monitoring central lubrication system	●	●		
可调节式动模板支撑装置	Adjustable support for moving platen	●	●	●	
液压自调节式动模板支撑装置	Self-adjust hydraulic support for moving plate				●
动模板移动高硬度钢带	High rigid steel slide tape for moving platen	●	●	●	
动模板移动高硬度轨道板	High rigid steel slide plate for moving platen				●
合模区移动安全顶盖板	Top safety cover for clamping unit	●	○		
自动安全门	Auto safety door	○	○	○	○
欧规18机械手安装位置	EUROMAP18 robot mechanical interface	●	●	●	●
动模板机械限位装置	Mechanical limit for moving platen	○	○	○	○
磁力模板	Magnetic platen	○	○	○	○
液压/电动旋转托模装置	Hydraulic/electrical mould unscrew device	○	○	○	○
模具吊装摆杆	Mould hanger	○			
加宽门窗	Widened door and covers	○	○	○	○
模区安全踏板	Safety pad under mould open/close area			○	○
一组分水器	One group of water regulators	●	●	○	○
两组分水器	Two groups of water regulators	○	○	●	●
快插接头分水器	Quick coupling for water regulator	○	○	○	○
两组吹气阀	Double air blaster	●	●	●	●
玻璃管冷却流量计	Glass cooling water regulator	○	○	○	○
调模自锁阀	Self-lock valve for mould height adjust	●	●	●	●

● 标准 standard ○ 可选 Optional



功 能 配 置 表
Components & functions list

DREAM-M系列功能配置表---液压

Components & Functions list—for Hydraulic

功 能 描 述 \ 注 射 单 元	Function description / Injection unit	i150-840	i1100-9200
伺服油泵	Servo motor pump	●	●
变量泵	Variable pump	○	○
定量泵	Fixed pump	○	○
电子变量泵	Electronic variable pump	○	○
加大油泵电机功率	With bigger pump and motor	○	○
多组顺序注射功能	Sequence injection valve control for injection	○	○
蓄能器快速注射	Quick injection with accumulator	○	○
注射伺服阀	Servo valve injection control	○	○
全蓄压控制	Fully accumulator control	○	○
液压油位报警	Oil level alarm	●	●
吸油口锁闭装置	Self-lock suction oil filter	●	●
冷水阀	Cooling water valve	○	○
功 能 描 述 \ 锁 模 单 元	Function description / Clamping unit	D45-250	D300-1050
2组抽芯（动模）	Two groupsof core pullings(on moving platen)	●	●
3组抽芯（动模2组，定模1组）	Three groupsofcore pullings(2 for moving platen,1 for fixed platen)	○	○
4组抽芯（动模2组，定模2组）	Four group of core pullings(2 for moving platen,2 for fixed platen)	○	○
合模差动装置	Quick clamping device	●	●
开模顶出同步（顶出无比例控制）	Eject while mould open (eject without proportional control)	○	○
开模顶出同步（顶出比例控制）	Eject while mould open (eject with proportional control)	○	○
开模储料同步（储料无比例控制）	Plasticizing while mould open (Plasticizing without proportional control)	○	○
开模储料同步（储料比例控制）	Plasticizing while mould open (Plasticizing with proportional control)	○	○
开模、顶出、储料同步（比例控制）	Plasticizing & eject while mould open (with proportional control)	○	○
开合模比例控制	Proportional control for clamping and open	○	○
开合模闭环控制	Close loop control for clamping and open	○	○
顶出闭环控制	Close loop control for eject	○	○

● 标准 standard ○ 可选 Optional

DREAM-M系列功能配置表---电气

Components & Functions list—for electrical

功 能 描 述 \ 注 射 单 元	Function description / Injection unit	i150-1900	i2500-5800	i7200-9200
弘讯控制器	TECHMATION Controller	●	●	●
杰佛伦控制器	GEFRAN Controller	○	○	○
200组模具记忆功能	200 groups mould parameter memory	●	●	●
各动作工况实时监视功能	All action instant monitoring	●	●	●
生产资料监测功能	Production monitoring	●	●	●
故障报警显示功能	Failure & alarm display	●	●	●
注射压力转保压功能	Hold on strat via Injection pressure	○	○	○
I/O监测显示	I/O monitoring interface	●	●	●
三色报警灯（带蜂鸣器）	3 color light (with buzzer)	●	●	●
电机过载保护	Motor overload protection	●	●	●
前、后门紧急停止按钮	Front/back door emergency stop switch	●	●	●
380V/16A五芯插座1组	5 pins socket of 380V/16A, one group	●		
380V/16A五芯插座2组	5 pins socket of 380V/32A, two groups	○	●	
220V/16A三芯插座1组	3 pins socket of 220V/16A, one group			
380V/32A五芯插座2组	5 pins socket of 380V/32A ,two groups			
380V/16A五芯插座1组	5 pins socket of 380V/16A ,one group	○	○	●
220V/16A三芯插座1组	3 pins socket of 220V/16A,one group			
伺服动力系统变电压	Transformor for servo motor system	○	○	○
变频节能	Power-saving with inverter	○	○	○
欧规12机械手接口	EUROMAP 12 robot interface	○	○	○
欧规67机械手接口	EUROMAP 67 robot interface	○	○	○
加热双重保护	Double protection for heating	●	●	●
安全继电器监控	Safety relay Monitoring	●	●	●
加热固态继电器控制	SSR heating control	●	●	●
计算机网络集中控制系统	Central network control system	○	○	○
热流道控制系统与接口	Hot runner control system & interface	○	○	○
实时能耗监测	Instant Power consumption monitoring	○	○	○
实时锁模力监控	Instant clamping force monitoring	○	○	○

● 标准 standard ○ 可选 Optional

DREAM-M系列功能配置表---其他

Components & Functions list—for other functions

功 能 描 述 \ 锁 模 单 元	Function description / Clamping unit	D45-600	D650-1050
泰瑞机器D标准颜色	TEDERIC standard color	●	●
防震机床垫脚	Shock-proof pad	●	●
附件箱、常用工具、模具压板、易损备件、加长喷嘴、说明书	Spare parts box, tools, mould clamps, easy broken parts, extended nozzle, operation manual.	●	●
特殊颜色	Special color	○	○
加高机身	Higher machine frame	○	○
机械手	Robot	○	○
磁力架（干燥料斗上配）	Magnetic (for hopper dryer)	○	○
冷水机	Chiller	○	○
模温机（控制模具温度）	Mould temp controller	○	○
除湿机	Dehumidifier	○	○
自动上料机	Autoloader	○	○
熏蒸木装箱	Fumigate wood packaging	○	○
机器装满液压油	With full-tank hydraulic oil	○	○
取制品平台	Products fetching platform	○	○

● 标准 standard ○ 可选 Optional

DREAM 多组份注射成型系列
DREAM multi components series



泰瑞多组份注塑机包括D-D清双色和D-C混双色两大系列，D-D系列包括转盘式、转轴式、无转盘转轴式等，D-C系列包括混色注射、夹层注射等。

TEDERIC multi components injection molding machines include clear dual color D-D series and marble dual color D-C series.TheD-D series include with rotate platen,Rotate spindle and without rotate platen/spindle.TheD-D series include with marble injection and sandwich injection.



D-C混双色技术参数表
Technical parameter table D-C

			单位 Unit	D160C						D200C						D250C											
				A	B	C	A	B	C	A	B	C	A	B	C	A	B	C									
注射装置 Injection Unit	螺杆直径	Screw Diameter	mm	35	38	42	28	32	35	35	38	42	35	38	42	42	45	50	35	38	42						
	螺杆长径比	Screw L/D Ratio		21.7	20.0	18.1	22.9	20.0	18.3	21.7	20.0	18.1	21.7	20.0	18.1	21.4	20.0	18.2	21.7	20.0	18.1						
	理论容量	Theoretical Shot Volume	cm³	168	198	242	89	117	140	168	198	242	168	198	242	287	329	406	168	198	242						
	注射重量(PS)	Injection Weight (PS)	g	153	181	221	81	106	127	153	181	221	153	181	221	261	299	369	153	181	221						
	注射压力	Injection Pressure	MPa	223.2	189.4	155.0	246.1	188.4	157.5	223.2	189.4	155.0	223.2	189.4	155.0	223.2	194.4	157.5	223.2	189.4	155.0						
	对空注射速率	Injection Rate Into Air	cm³/s	96.8	114.1	139.4	58.5	76.5	91.5	96.8	114.1	139.4	96.8	114.1	139.4	119.2	136.8	168.9	96.8	114.1	139.4						
	注射行程	Injection Stroke	mm	175				144				175				175				207				175			
	注射线速度	Injection Speed	mm/s	101				95				101				101				86				101			
螺杆转速	Screw Rotation Speed	rpm	218				210				218				218				186				218				
合模装置 Clamping Unit	合模力	Clamping Force	kN	1600						2000						250											
	移模行程	Clamping Stroke	mm	480						540						550											
	拉杆内距	Tie Bar Distance	mm	470X470						530X530						580X580											
	最大模厚	Max.Mold Height	mm	530						560						600											
	最小模厚	Min.Mold Height	mm	200						220						250											
	顶出行程	Eject Stroke	mm	150						150						160											
	顶出力	Eject Force	kN	34						67						67											
	顶出杆根数	No.Of Ejector Pins	Piece	5						9						9											
其他 Others	最大油泵压力	Max.Pump Pressure	MPa	17.5						17.5						17.5											
	油泵马达功率	Pump Motor Power	kW	22						26						29											
	电热功率	Heater Power	kW	8.2				6.7				8.2				8.2				8.2							
	料斗容积	Hopper Capacity	L	25				25				25				25				25							
	油箱容积	Oil Tank Capacity	L	350						400						550											
	重量	Weight	t	5.6						7.1						8.5											

因设计更新，以上参数如有改动，恕不另行通知。以上为配置伺服系统时的参数，配置其他形式动力，参数将略有不同，详情请洽泰瑞公司。
Due to continuous improvements,we reserve the right to amend any aspect of the above specifications without further notice.The above lists is for machine with servo motor system.
For machine with other motor system,the parameters may be a little different.Please check with TEDERIC for the details.



D-D清双色技术参数表
Technical parameter table D-D

			单位 Unit	D160D						D230D						D320D							
				A	B	C	A	B	C	A	B	C	A	B	C	A	B	C	A	B	C		
注射装置 Injection Unit	螺杆直径	Screw Diameter	mm	35	38	42	28	32	35	35	38	42	35	38	42	45	50	55	35	38	42		
	螺杆长径比	Screw L/D Ratio		21.7	20.0	18.1	22.9	20.0	18.3	21.7	20.0	18.1	21.7	20.0	18.1	22.2	20.0	18.2	21.7	20.0	18.1		
	理论容量	Theoretical Shot Volume	cm³	168	198	242	89	117	140	168	198	242	168	198	242	358	442	535	168	198	242		
	注射重量(PS)	Injection Weight (PS)	g	153	181	221	81	106	127	153	181	221	153	181	221	326	402	486	153	181	221		
	注射压力	Injection Pressure	MPa	223.2	189.4	155.0	246.1	188.4	157.5	223.2	189.4	155.0	223.2	189.4	155.0	235.3	190.6	157.5	223.2	189.4	155.0		
	对空注射速率	Injection Rate Into Air	cm³/s	96.8	114.1	139.4	58.5	76.5	91.5	96.8	114.1	139.4	96.8	114.1	139.4	141.3	174.5	211.1	96.8	114.1	139.4		
	注射行程	Injection Stroke	mm					175					175					225					175
	注射线速度	Injection Speed	mm/s					101					101					89					101
	螺杆转速	Screw Rotation Speed	rpm					218					218					192					218
合模装置 Clamping Unit	合模力	Clamping Force	kN	1600						2300						3200							
	移模行程	Clamping Stroke	mm	400						450						550							
	拉杆内距	Tie Bar Distance	mm	700X420						920X480						970X560							
	最大模厚	Max.Mold Height	mm	450						500						600							
	最小模厚	Min.Mold Height	mm	150						180						200							
	顶出行程	Eject Stroke	mm	130				130				110				110				130			
	顶出力	Eject Force	kN	34				34				34				34				67			
	顶出杆根数	No.Of Ejector Pins	Piece	1				1				1				1				5			
	模具定位中心距	Distance Between Molds Positing Cengters	mm	420						450						520							
转盘直径	Diameter of rotation platen	mm	800						1000						1200								
其他 Others	最大油泵压力	Max.Pump Pressure	MPa	17.5				17.5				17.5				17.5							
	油泵马达功率	Pump Motor Power	kW	13				9				13				13							
	电热功率	Heater Power	kW	8.2				6.7				8.2				8.2							
	料斗容积	Hopper Capacity	L	25				25				25				25							
	油箱容积	Oil Tank Capacity	L	500						500						850							
	重量	Weight	t	8						11						14.5							

			单位 Unit	D500D						D900D						D1500D					
				A	B	C	A	B	C	A	B	C	A	B	C	A	B	C			
注射装置 Injection Unit	螺杆直径	Screw Diameter	mm	60	65	70	35	38	42	65	70	75	42	45	50	75	80	85.7	50	55	60
	螺杆长径比	Screw L/D Ratio		21.7	20.0	18.6	21.7	20.0	18.1	23.7	22.0	20.5	21.4	20.0	18.0	23.5	22.0	20.7	22.0	20.0	18.3
	理论容量	Theoretical Shot Volume	cm³	845	992	1151	168	198	242	1161	1347	1546	287	329	406	1785	2031	2292	497	601	715
	注射重量(PS)	Injection Weight (PS)	g	769	903	1047	153	181	221	1057	1226	1407	261	300	370	1624	1848	2086	452	547	651
	注射压力	Injection Pressure	MPa	235.3	200.5	172.9	223.2	189.4	155.0	219.1	188.9	164.6	223.2	194.4	157.5	210.3	184.8	163.7	226.8	187.4	157.5
	对空注射速率	Injection Rate Into Air	cm³/s	216.7	254.3	294.9	96.8	114.1	139.4	273.1	316.8	363.7	149.0	171.0	211.1	395.2	449.7	507.7	224.8	272.0	323.7
	注射行程	Injection Stroke	mm	299			175			350			207			404			253		
	注射线速度	Injection Speed	mm/s	77			101			82			108			90			115		
螺杆转速	Screw Rotation Speed	rpm	158			218			158			232			157			232			
合模装置 Clamping Unit	合模力	Clamping Force	kN	5000						9000						15000					
	移模行程	Clamping Stroke	mm	840						1130						1520					
	拉杆内距	Tie Bar Distance	mm	820X820						1080X1080						1460X1360					
	最大模厚	Max.Mold Height	mm	650						970						1250					
	最小模厚	Min.Mold Height	mm	220						400						500					
	顶出行程	Eject Stroke	mm	150			150			280			280			320			320		
	顶出力	Eject Force	kN	67			67			124			124			182			182		
	顶出杆根数	No.Of Ejector Pins	Piece	5			5			5			5			5			5		
	模具定位中心距	Distance Between Molds Positing Cengters	mm	500						630						710					
	转盘直径	Diameter of rotation platen	mm	1100						1400						1980					
其他 Others	最大油泵压力	Max.Pump Pressure	MPa	17.5			17.5			17.5			17.5			17.5			17.5		
	油泵马达功率	Pump Motor Power	kW	31			13			36			20			50			31		
	电热功率	Heater Power	kW	30.6			8.2			26.4			12.9			45.9			19.7		
	料斗容积	Hopper Capacity	L	50			25			50			25			50			50		
	油箱容积	Oil Tank Capacity	L	1000						1200						2100					
重量	Weight	t	21						48						72						

因设计更新，以上参数如有改动，恕不另行通知。以上为配置伺服系统时的参数，配置其他形式动力，参数将略有不同，详情请洽泰瑞公司。
Due to continuous improvements,we reserve the right to amend any aspect of the above specifications without further notice.The above lists is for machine with servo motor system.
For machine with other motor system,the parameters may be a little different.Please check with TEDERIC for the details.