

DREAM-H 系列二板机特点

DREAM-H SERIES FEATURES

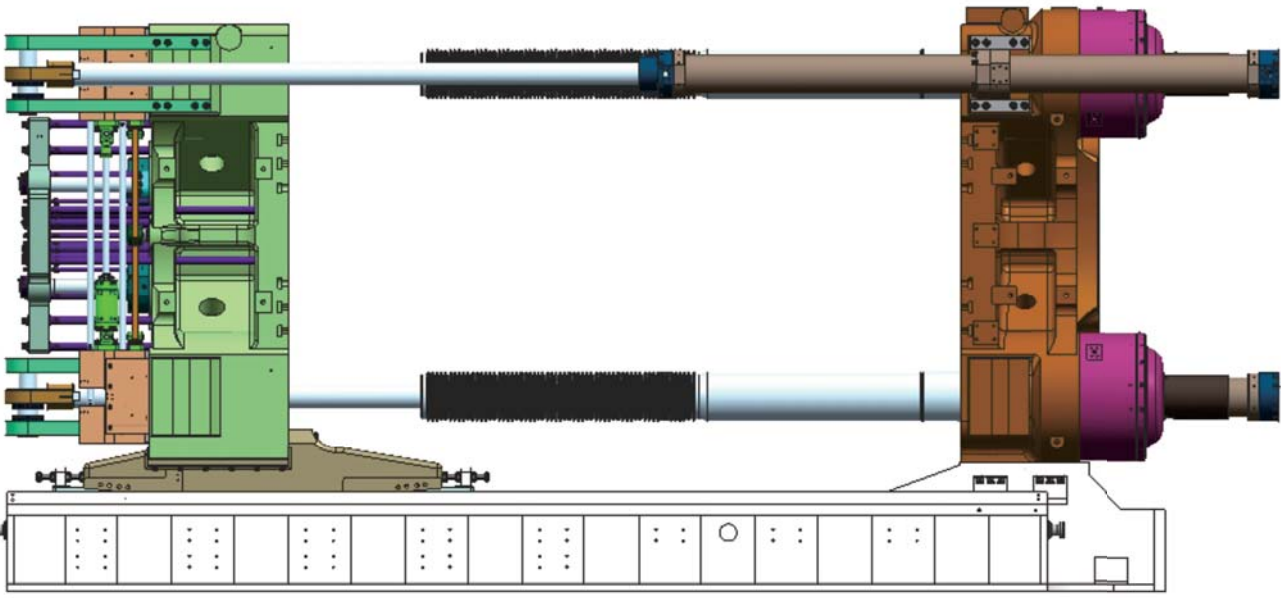

超大容量及开模行程
Huge opening stroke and mould thickness

高刚性及超长二板滑脚机构，模具承重能力大幅提升
High rigidity and long platen shoes structure could greatly increase the bearing capacity for mould

短程锁模油缸可快速建立锁模力，模具受力均匀
Short distance mould clamping cylinder could quickly build the clamping force, which is good for uniform force for mould

同步抱闸螺母结构，抱闸更快更准
Synchronous half-nut locking mechanism could ensure faster and accurate lock

顶出油缸对角布置并反装在模板里，更省空间
Opposite angles layout and anti-equipped ejector cylinders save space

锁模机身刚性提升，开关模更加平稳
More rigidity machine frame ensures stable movements for mould open and close

液压油路重新布局，整机更简洁，更富美感
Re-design of hydraulic channel is more concise and beauty

模板开距大，更适合深腔模具；
移模油缸模块化设计，可根据客户需要加大开模力或加长行程。
Long distance between the two platens is suitable for deep cavity mould
Modular design of moving cylinder could meet the customer requirements of increasing mould opening force and extending the stroke.

移模油缸铰接固定到模板上，有效避免由于移动模板移动过程中的晃动造成油缸的损坏；
移模油缸对角布置，并预留另外对角的安装位置，便于加大开模力；
The hinge joint of moving cylinder fixed on the platen avoids damage of cylinder during the movement of platen;
Opposite angles layout of moving cylinders and additional reservation of installation are convenient for increasing mould opening force.

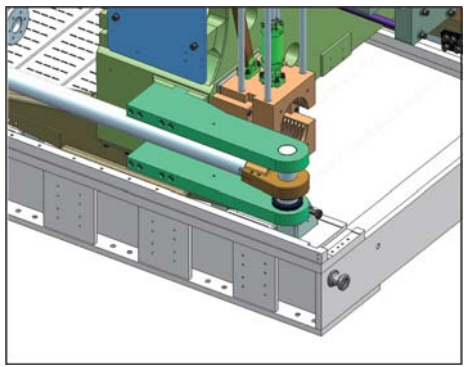

TEDERIC

泰瑞机器股份有限公司
TEDERIC MACHINERY CO.,LTD

杭州经济技术开发区文泽北路245号

Add: No 245, North Wenzhe Road, Hangzhou

Economic & Technological Development Area, China

P.C.: 310016

TEL: +86-571-86733377 (内销) +86-571-86733389 (Overseas)

FAX: +86-571-87322905

E-mail: tederic@tederic-cn.com jgzheng@mailhz.zj.cn



Dream-H

SERIES TWO-PLATEN INJECTION MOLDING MACHINE

梦想系列二板式塑料注射成型机

泰瑞机器 共塑梦想
TEDERIC MACHINERY MOLDING DREAMS



SERIES TWO-PLATEN INJECTION MOLDING MACHINE

梦想系列二板式塑料注射成型机

DREAM-H 系列二板机特点

DREAM-H SERIES FEATURES

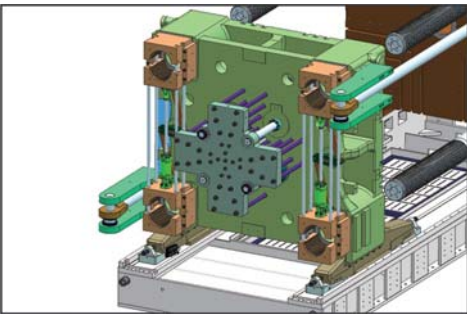
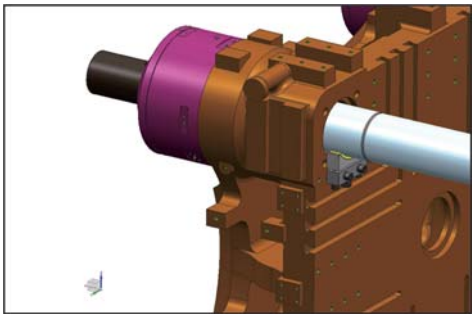

锁模油缸的拉杆上设置独特的拉杆支撑结构并可张紧调节，有效避免拉杆下垂，此技术已获国家专利；
相对尾架式拉杆支撑，及移动模板与拉杆导向的结构，成本更低，更有效。
Structural support of the tie bars on the clamping cylinder could effectively avoid tie bars drooping by tensing the adjustment.
(This structure is under patent protection)
Compared with end support structure of the tie bars and guide structure between moving platen and tie bars, the cost is lower and works more effectively.

上下闸板设置定位孔，抱闸时定位拉杆，拉杆环形槽受力均匀；当拉杆位置，模板位置在初始记录位置时，即可同步抱闸，取消对齿开关检测，确保抱闸准确，稳定可靠。
Up and down movement of half-nut reduces the center deviation, ensuring uniform stress to tie bars circular groove;
Position of tie-bar and moving platen, location of half-nut and tie-bar annular gear are at the same position when half-nut locks, ensuring accurate lock for half-nut.

顶出油缸对角布置，顶出力更大，顶出板受力均衡；通用的顶出反拉结构，便于顶出杆安装；
顶出油缸反装，缩短机器的占地空间；顶出油缸进出油口特殊设计，液压布管整洁，美观，此技术已获国家专利。
Opposite angle layout ensures heavier ejecting force and uniform stress to ejector plate; It is easier for installation and less area occupied;
Special design of oil inlet and outlet makes hydraulic pipes uncluttered. (This structure is under patent protection).

DREAM-H 系列二板机技术参数表

DREAM-H SERIES PARAMETER LIST

				D850H/7500					D1100H/9500					D1300H/13500					D1600H/13500					D1850H/17800				
			Unit	A	B	C	D	A	B	C	D	A	B	C	D	A	B	C	D	A	B	C	D					
注射装置	螺杆直径	Screw diameter	mm	90	100	110	120	100	110	120	130	120	130	140	150	120	130	140	150	130	140	150	160					
	螺杆长径比	Screw L/D ratio		24.4	22.0	20.0	18.3	24.2	22.0	20.2	18.6	23.8	22.0	20.4	19.1	23.8	22.0	20.4	19.1	23.7	22.0	20.5	19.3					
	理论容量	Shot size(theoretical)	cm³	3276	4045	4894	5825	4320	5227	6220	7300	6775	7951	9221	10585	6775	7951	9221	10585	9145	10606	12176	13853					
	注射重量 (PS)	Injection weight(PS)	g	2981	3681	4454	5300	3931	4756	5661	6643	6165	7235	8391	9633	6165	7235	8391	9633	8322	9652	11080	12606					
	注射压力	Injection pressure	MPa	231.1	187.2	154.7	130.0	220.2	181.9	152.9	130.3	195.6	166.6	143.7	125.2	195.6	166.6	143.7	125.2	194.8	168.0	146.3	128.6					
	对空注射速率	Injection rate into air	cm³/s	540/662	666/817	806/989	959/1177	665/793	804/959	957/1142	1123/1340	816	958	1111	1275	816	958	1111	1275	970	1125	1291	1469					
	注射行程	Injection stroke	mm		515				550				599				599				689							
	注射线速度	Injection speed	mm/s	85	/	104		85	/	101			72				72				73							
	螺杆转速	Screw Rotation speed	rpm	102.9	/	126.3		92.0	/	109.8			88				88				86							
合模装置	合模力	Clamping force	kN		8500				11000				13000				16000				18500							
	开模力 (顶模油缸)	Open mold force	kN		929				1001				1288				1697				1697							
	开模力 (移模油缸)	Open mold force	kN		275				332				425				492				565							
	移模油缸行程	Clamping cylinder stroke	mm		2050				2100				2300				2600				2600							
	拉杆内距	Tie bar distance	mm		1080x1080				1180x1180				1380x1280				1570x1470				1680x1520							
	最大模厚	Max. mold height	mm		1100				1200				1350				1600				1700							
	最小模厚	Min. mold height	mm		450				500				600				650				700							
	模板最大开距	Max.platen distance	mm		2500				2600				2900				3250				3350							
	顶出行程	Eject stroke	mm		350				350				350				400				400							
	顶出力	Eject force	kN		260				260				260				430				430							
顶针数	No. of ejector pins	Piece		25				25				25				29				29								
其他	最大油泵压力	Max. pump pressure	MPa		17.5				17.5				22.5,16				22.5,16				22.5,16							
	油泵马达功率	Pump motor power	kW	75+31	/	92+31		88+31	/	105+31			105+31				105+31				124+31							
	电热功率	Heat power	kW	55.8	/	69.2		63.0	/	78.1			84.7				84.7				93.0							
	料斗容积	Hopper capacity	L		150				200				200				200				200							
	油箱容积	Oil tank capacity	L		1400				1700				2500				2500				4200							
	机器重量	Machine weight	t		32				45				62				78				88							
机器尺寸			Machine dimension	10000X2900X2560				10800X3100X2700				11800X3150X2880				12200X3150X2970				12800X3600X3300								

			Unit	D2050H/24000				D2500H/37000				D2850H/54000				D3350H/66600				D4050H/91600				D6000H/91600			
				A	B	C	D	A	B	C	D	A	B	C	D	A	B	C	D	A	B	C	D	A	B	C	D
注射装置 Injection Unit	螺杆直径	Screw diameter	mm	150	160	170	185	170	180	190	200	190	200	210	220	200	210	220	230	230	240	250	260	230	240	250	260
	螺杆长径比	Screw L/D ratio		23.5	22.0	20.7	19.0	23.3	22.0	20.8	19.8	23.2	22.0	21.0	20.0	23.1	22.0	21.0	20.1	23.0	22.0	21.1	20.3	23.0	22.0	21.1	20.3
	理论容量	Shot size(theoretical)	cm³	13943	15864	17909	21209	22698	25447	28353	31416	32577	36097	39797	43677	39553	43607	47859	52308	53139	57861	62783	67906	53139	57861	62783	67906
	注射重量 (PS)	Injection weight(PS)	g	12688	14436	16297	19300	20655	23157	25801	28588	29645	32848	36215	39746	35993	39682	43551	47601	48357	52653	57132	61794	48357	52653	57132	61794
	注射压力	Injection pressure	MPa	173.4	152.4	135.0	114.0	163.3	145.7	130.7	118.0	167.1	150.8	136.8	124.6	171.1	155.2	141.4	129.4	172.3	158.3	145.9	134.9	172.3	158.3	145.9	134.9
	对空注射速率	Injection rate into air	cm³/s	1309	1490	1682	1992	1613	1809	2015	2233	1865	2066	2278	2500	1821	2008	2203	2408	2675	2913	3161	3419	2675	2913	3161	3419
	注射行程	Injection stroke	mm		789				1000				1149				1259				1279				1279		
	注射线速度	Injection speed	mm/s		74				71				66				58				64				64		
	螺杆转速	Screw Rotation speed	rpm		73				51				60				53				65				65		
	合模力	Clamping force	kN		20500				25000				28500				33500				40500				60000		
合模装置 Clamping Unit	开模力 (顶模油缸)	Open mold force	kN		1697				2042				2289				2550				3116				4069		
	开模力 (移模油缸)	Open mold force	kN		643				643				726				907				1005				1329		
	移模油缸行程	Clamping cylinder stroke	mm		3250				3300				3300				3400				3600				4700		
	拉杆内距	Tie bar distance	mm		1800x1600				1900x1700				2020x1800				2200x1900				2420x2020				3200x2600		
	最大模厚	Max. mold height	mm		1900				1900				1900				2000				2100				4500		
	最小模厚	Min. mold height	mm		700				800				800				900				1000				2000		
	模板最大开距	Max.platen distance	mm		3950				4100				4100				4300				4600				6700		
	顶出行程	Eject stroke	mm		400				500				500				560				560				1200		
	顶出力	Eject force	kN		430				560				560				560				560				1100		
	顶针数	No. of ejector pins	Piece		37				41				41				41				41				41		
其它 Others	最大油泵压力	Max. pump pressure	MPa		22.5,16				22.5,16				22.5,16				22.5,16				22.5,16				22.5,16		
	油泵马达功率	Pump motor power	kW		149+31				180+31				205+31				205+31				303+31				303+31		
	电热功率	Heat power	kW		102.0				150.0				184.0				211.0				225.0				225.0		
	料斗容积	Hopper capacity	L		200				400				400				400				400				400		
	油箱容积	Oil tank capacity	L		4200				4200				4200				4500				7000				7000		
	机器重量	Machine weight	t		110				131				149				190				248				248		
	机器尺寸	Machine dimension	mm		13500X4500X3460				15600X5000X3900				16500X5000X4000				17500X5500X4200				21500X6000X4300				25500X6800X4800		